



Self-Monitoring Blood Glucose System
(Affordable Care Meter)

User's Manual

**Please read this User's Manual thoroughly
before using your blood glucose meter.**

Dear **EASYMAX® T1 SMBG System Owner,**

Thank you for using the **EASYMAX® T1** Self-Monitoring Blood Glucose (SMBG) System. We designed this system to be dependable, easy-to-use, compact, lightweight and portable to help you monitor your blood glucose on a regular basis.

Please read this manual thoroughly before you begin testing. This manual provides you and your diabetes care team with important information and step-by-step directions to use the **EASYMAX® T1** Self-Monitoring Blood Glucose System.

Thanks again for choosing the **EASYMAX® T1** SMBG System.

Intended Use

The **EASYMAX® T1 Self-Monitoring Blood Glucose Test System** is intended for the quantitative measurement of glucose in fresh capillary whole blood from fingertip. Testing is done outside the body (*In Vitro* diagnostic use). It is indicated for use at home (over the counter [OTC]) by a single patient with diabetes, or in clinical settings by healthcare professionals, as an aid to monitor the effectiveness of diabetes control. The system is not to be used on neonates or arterial blood, nor for the diagnosis of, or screening for diabetes mellitus.

Important Safety Instructions

Lancets and test strips are for single use only. A new, sterile lancet should be used each time you perform a test. The lancing device, lancets, test strips and meter are NOT to be shared between users or other family members. Do NOT use it on multiple individuals. Sharing a lancing device and lancets may transmit bloodborne pathogens, such as viral hepatitis.

All parts of the kit are considered biohazardous and may transmit infection, even if you have performed cleaning and disinfection. Wash your hands thoroughly with soap and water after handling the meter, test strips, lancets or lancing device.

For further information, please see: "FDA Public Health Notification: Use of Fingertick Devices on More than One Person Poses Risk for Transmitting Bloodborne Pathogens: Initial Communication" (2010)
<http://www.fda.gov/MedicalDevices/Safety/AlertsandNotices/ucm224025>.

"CDC Clinical Reminder: Use of Fingertick Devices on More than One Person Poses Risk for Transmitting Bloodborne Pathogens" (2010)
<http://www.cdc.gov/injectionsafety/Fingertick-DevicesBGM.html>.

Standard Accessories

Your new **EASYMAX® T1** Blood Glucose meter and accessories work together to measure the amount of glucose in your blood. The system includes:

- **Blood Glucose Meter**
- **1 ct. CR2032 Battery**
- **25 ct. Foiled Pack Test Strip**
- **Lancing Device**
- **10 ct. Lancet**
- **User`s Manual**
- **Self-Test Logbook**
- **Carrying Case**

Optional Accessories

- **Level 2 Control Solution**
- **Level 3 Control Solution**

Note: For optional accessories purchase, please call the Customer Care Service toll-free at 866-994-3345 (Eastern Standard Time, Mon-Fri 8:00AM~6:00PM).

Why is it so important to test blood glucose regularly?

Testing your blood glucose regularly can make a big difference in how you manage your diabetes every day. We've made this SMBG system as simple as possible to help you to use the meter regularly. Your meter is easy to use, and you can adjust the lancing device for your comfort.

Do you need Help?

If you have questions or need assistance, please call the Customer Care Service toll-free at 866-994-3345 (Eastern Standard Time, Mon-Fri 8:00AM~6:00PM). or E-mail: [**contact@oaktree-health.com**](mailto:contact@oaktree-health.com). You can also visit [**www.oaktree-health.com**](http://www.oaktree-health.com) for diabetes management tools and product demonstrations.

Note:

Although the EASYMAX® T1 SMBG System is easy to use, you may need to consult your healthcare professional (this may be your doctor, pharmacist or certified diabetes nurse educator) for instructions on how to use the system. Only the correct use of the system will ensure accurate results.

Important Information about Your New Meter

- **EASYMAX® T1** blood glucose meter is designed and approved for testing fresh capillary whole blood samples from your fingertip. The meter is for *in vitro* diagnostic use ONLY (for testing outside the body). It should not be used to diagnose or screen for diabetes.
- **EASYMAX® T1** blood glucose meter can only be used with **EASYMAX®** Blood Glucose Test Strips. Other test strips will give inaccurate results.
- Testing is not valid for neonatal blood specimens.
- Do not disassemble the meter as this may cause damage to the components resulting in incorrect readings. Disassembling the meter will also void the warranty.
- Always keep the meter clean and store it in a safe place. Protect the meter from direct sunlight to ensure a longer lifespan.
- You should not store the meter and test strips in a car or a bathroom.
- Keep the meter, test strips and lancing device away from children and pets.
- You should not test critically ill patients with home-use blood glucose meters.
- Incorrect results may occur when performing the test. If your glucose results do not match how you feel, please contact your healthcare professional immediately.
- Remove batteries if the meter will not be used for one month or more.
- Do not touch the strips with wet hands.

- Do not use expired strips (the expiration date is shown on the bottle).
- Do not bend, cut or twist the strips.
- Altitude up to 10,000 feet above sea level has no effect on readings.

Health-Related Information

- If you are very dehydrated, urinating frequently, have low blood pressure, shock or hyperosmolar hyperglycemic nonketotic coma (HHNK), you may get a test result that is lower than what your blood glucose really is. If you think you are dehydrated, call your doctor right away.
- If you have followed the steps in the user's manual, but still have symptoms that don't seem to match your test results, contact your Healthcare Professional or physician immediately. If you have questions regarding the use of the meter, please call the Customer Care Service toll-free at 866-994-3345 (Eastern Standard Time, Mon-Fri 8:00AM~6:00PM). During non-service hours, please contact your healthcare provider.
- Please read your test strip instruction carefully for additional health-related information.





Table of Contents

Chapter 1: Understanding Your Meter	10
The EASYMAX® T1 Blood Glucose Meter	10
The EASYMAX® Accessories	11
Inserting A Battery.....	12
Using EASYMAX® Blood Glucose Test Strip.....	13
Chapter 2: Control Solution Test	14
Why Run a Control Solution Test	14
About The Control Solutions	15
Running A Control Solution Test	16
Understanding Control Solution Test Results	18
Chapter 3: Testing Your Blood Glucose	20
Using The Lancing Device	20
Inserting A Lancet into the Lancing Device	21
Running A Blood Glucose Test with Blood from Your Fingertip	23
Discarding Used Lancets	25
Understanding Your Test Results	26
Unusual Test Results	26
Comparing Your Meter Result to a Lab Result	27

Chapter 4: Maintenance and Troubleshooting	28
Installing Batteries	28
Cleaning And Disinfecting Your Meter and Lancing Device.....	29
Cleaning and Disinfection Frequency.....	34
Maintenance And Testing	35
Screen Messages and Troubleshooting	36
Chapter 6: Technical Information	39
Specifications	39
Limitation	40
Device Information	42
Warranty	43

Chapter 1: Understanding Your Meter

The EASYMAX® T1 Blood Glucose Meter

Icon	Intended meaning
	Result / Message
mg/dL	Glucose unit
	Apply blood
	Insert a strip
	Battery
	Temperature

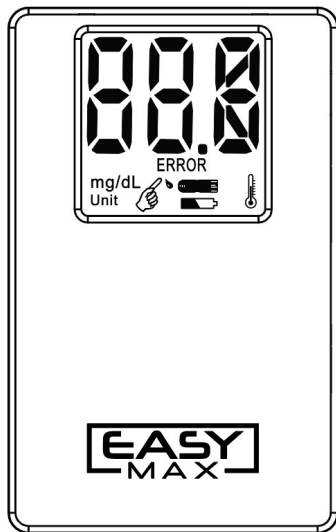

The EASYMAX® Accessories

Blood Glucose Test Strip

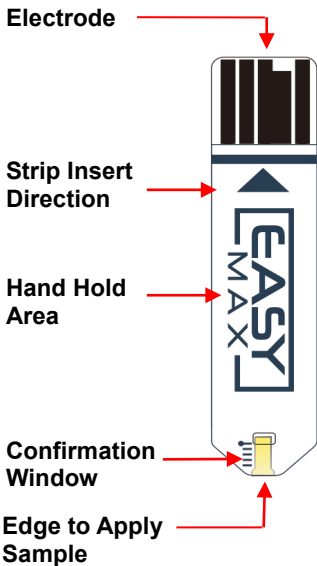

Test Strip Bottle Control Solution Bottle

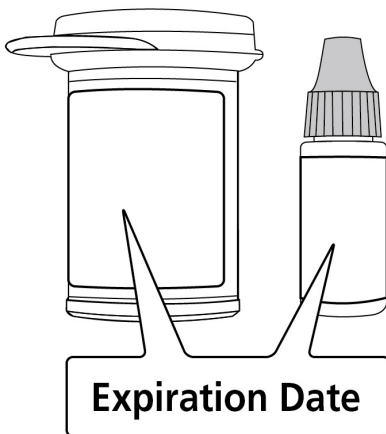

Lancing Device

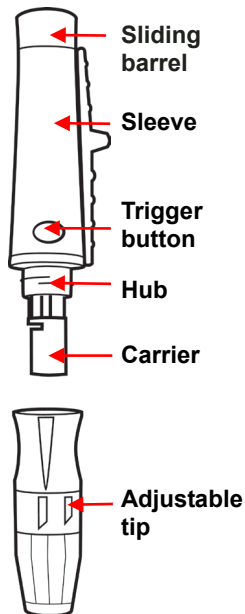

Inserting A Battery

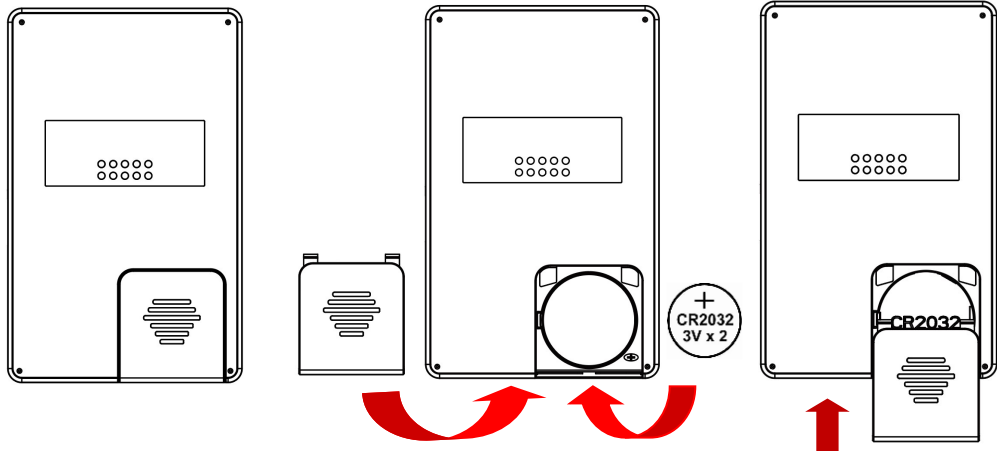

1. Open the battery door on the back of the meter by pushing the tab in the direction of the arrow.

2. Insert a battery. The meter will beep to confirm the battery is inserted correctly.

3. Put the battery door back in place and snap it closed.

Using EASYMAX® Blood Glucose Test Strip

- Use only with **EASYMAX® T1** Blood Glucose Meter.
- Run a control solution test every time you open a new box of test strips (See Chapter 2 "Control Solution Testing.").
- After you take a test strip out from the foil pack (see test strip manual), use immediately and properly dispose of the test strip.
- Use the test strip within three minutes after you take out of foil pack.
- The strip is for single use only. Do not reuse it.
- Be sure to check the "Expiration date" on the test strip box.
- Store the test strips and your meter in a cool dry place.
- Store the test strips between 36°F - 86°F (2°C - 30°C). Do not freeze.
- Do not apply blood or control solution to the test strip until you insert it into the meter.
- Do not touch the test strip with wet hands. Do not bend, cut, or twist the test strips.
- **EASYMAX® T1** Self-Monitoring Blood Glucose Test System is a "no code" system and does not require any meter calibration.

Chapter 2: Control Solution Testing

Why Run a Control Solution Test

We recommend that you run **EASYMAX®** Control Solution Test. Such a test will let you know that your meter and test strips are working properly to give reliable results. You should run the control solution tests when:

- You use the **EASYMAX® T1** Blood Glucose Meter for the first time.
- You think the meter or test strips may be working incorrectly.
- You drop the meter.
- You have repeated a test and the test results are still lower or higher than expected.
- You are practicing the test procedure.

About The Control Solution

- Use only with **EASYMAX®** test strips.
- Write the date you opened the bottle on the bottle label. The control solution is good for 3 months from the date the bottle is opened or until the expiration date on the bottle, whichever comes first.
- Do not use a control solution that is past the expiration date.
- The control solution can stain clothing. If you spill it, wash your clothes with soap and water.
- Close the bottle tightly after every use.
- Left over control solution should be properly disposed and not be added back into the control bottle.
- Store the bottle of control solution at room temperature, between 36°F - 86°F (2°C- 30°C). Do not freeze.
- If you would like to purchase additional **EASYMAX®** Control Solution(s), please contact your local dealer.

Running A Control Solution Test

You need the meter, test strip, and control solution.

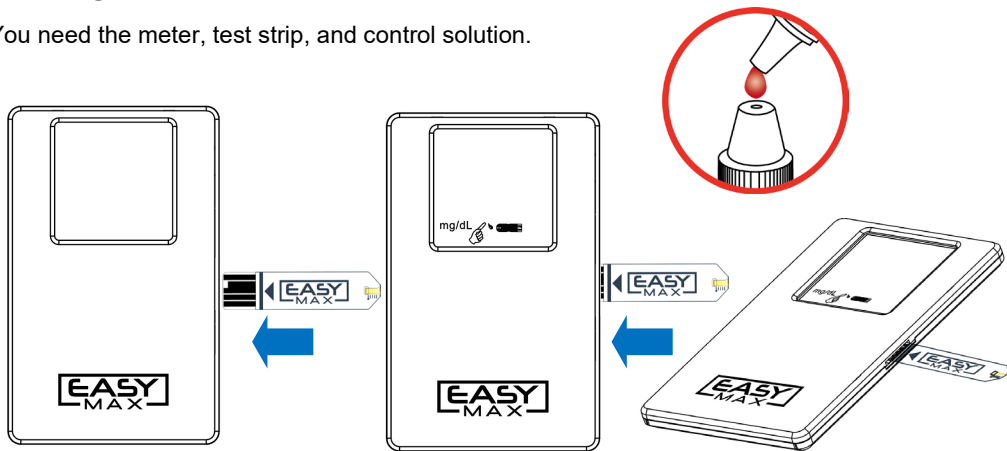

1. Put a test strip into the meter in the direction of the arrow. The meter turns on.
2. Place the meter on a flat surface, like a table.
3. Remove the control solution bottle cap and wipe the tip of the bottle with a tissue.
4. Squeeze the bottle until a tiny drop forms at the tip of the bottle and place solution on top of bottle cap.

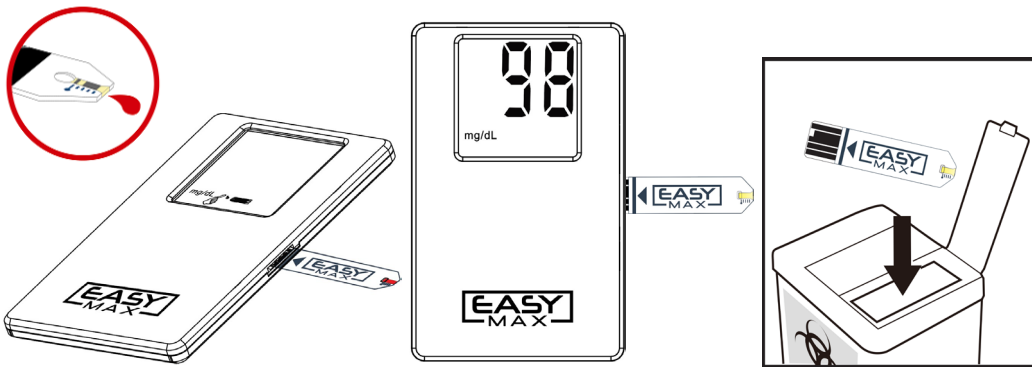

7. Do not remove the test strip yet. Check if the reading falls within the range printed on the test strip bottle.
8. Remove the test strip and properly throw it away after you have compared the reading to the range printed on the test strip bottle.
5. Touch the drop on the bottle to cap the tip of the test strip. Do not put control solution on top of the test strip.
6. When you hear the **beep**, you have enough control solution in the test strip.
The meter starts to count down from 5 seconds and then will display result

Note: Be aware that there are Level 1, 2 and 3 ranges listed on your test strip bottle. The Level 1, 2 and 3 refer to the three different control solutions that are available. Please be sure that you are looking at the correct range.

Understanding Control Solution Test Results

The label on your test strip bottle shows the acceptable ranges for the Control Solutions – Level 2, and Level 3. The result you get should be inside the acceptable range for the appropriate control solution level. Make sure you compare the result to the correct level of control.

When the control result is inside the range on the test strip bottle, your test strips and your meter are working properly.

If your control solution result is not inside the acceptable range (printed on your test strip bottle), here are some things you can do to solve the problem:

<i>Troubleshooting Checks</i>	<i>Action</i>
✓ Was the test strip exposed to open air for a long period of time?	Repeat the control test with properly stored strips.
✓ Was the test strip foil pack left open?	If the foil pack was left open, get a new unopened test strip and test again.
✓ Is the meter functioning well?	If not, you can use your control solution to verify the meter's functions. (Chapter 2)
✓ Is the control solution expired or contaminated?	Replace with new control solution to check the performance of SMBG system.
✓ Were test strips and control solutions stored in cool, dry places?	Repeat the control test with properly stored strips and/or control solutions.
✓ Did you follow the testing steps properly?	Read Chapter 2 "Control Solution Testing" and test again. Stop using the meter if you continue to obtain inaccurate results. Please contact the EASYMAX® Customer Care Service line at 866-994-3345 (Eastern Standard Time, Mon-Fri 8:00AM~6:00PM) for further troubleshooting.

Chapter 3: Testing Your Blood Glucose

Using The Lancing Device

- The best depth setting is the lowest setting that draws enough blood for a test. Try different settings to find the one that's right for you.
- Please do not share your lancing device with anyone and always use a new, sterile lancet. Lancets are for one time use only.
- If the meter and lancing device are being operated by a second person who is providing testing assistance to the user, the meter and lancing device should be disinfected prior to use by the second person. For the disinfection instructions, please refer to Chapter 5: Maintenance And Troubleshooting "Cleaning and disinfecting your meter and supplies".

Note:

Used test strips and lancets are considered bio-hazardous waste in accordance with local regulations and should be handled as if capable of transmitting infection. The users may discuss methods for disposing of used test strips and lancets with their healthcare professional.

Inserting A Lancet into The Lancing Device

You must first load the lancet into the lancing device to get it ready for use.

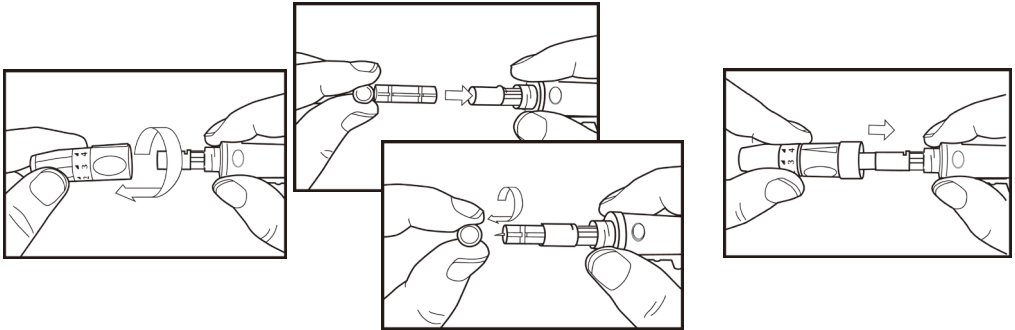

1. Unscrew the cap.

2. Insert the lancet into the lancing device firmly then twist off the protective cover.

3. Recap the front cap.

Note:

1. Lancets are for single use only and a new, sterile lancet should be used each time you perform a test.
2. Lancing device and lancets are NOT to be shared between users. Sharing lancing devices and lancets may transmit blood-borne pathogens, such as viral hepatitis.

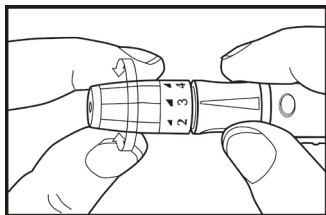

4. Select the desired penetration depth.

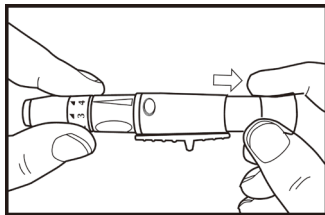

5. Pull on the sliding barrel of the lancing device until it clicks and then release.

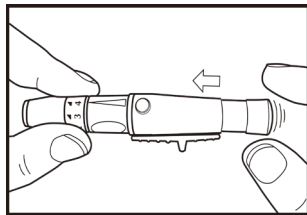

6. Now the lancing device is ready. Do not prick your finger until your meter and strip are prepared.

Note:

Select 1-2 for soft or thin skin, 3-4 for average, and 5-6 for thick or calloused skin.

Running A Blood Glucose Test with Blood From Your Fingertip

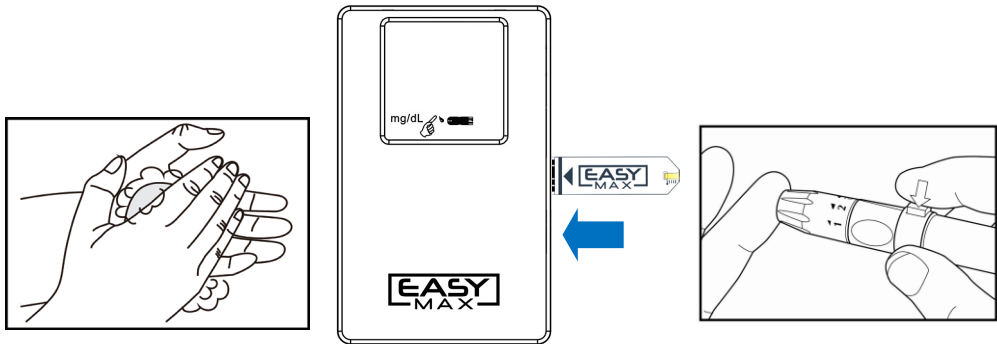

- 1.** Wash your hands with soap and warm water. Rinse and dry thoroughly.
- 2.** Put a test strip into the meter in the direction of the arrow. The meter turns on.
- 3.** When the blood drop flashes on the display, obtain a drop of blood from your fingertip, using the lancing device.
- 4.** Place the lancing device against the pad of your fingertip. Press the trigger button to activate the lancing device.

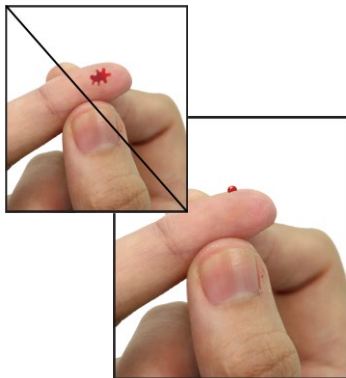

Apply blood to the edge of the test strip.

Do not apply blood on top of the test strip.

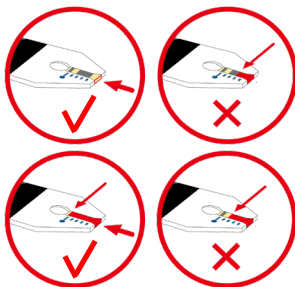

Be sure to get enough blood on strip to make it to the confirmation window.

Not enough blood on strip to get a test result.



5. Gently squeeze and/or massage your fingertip until a round drop of blood on your fingertip.

6. Touch the blood drop at the tip of the transparent window of the test strip. **Do not put blood on top of the strip.** Be sure to get enough blood on the strip's reaction zone. Otherwise, an inaccurate reading may result.

7. The meter will beep when enough blood has entered the strip's reaction zone. The result will appear on the display after 5 seconds.
8. Remove the test strip and the meter turns off automatically.
9. Wash hands thoroughly with soap and water after handling the meter, lancet device and test strips.

Note: Please make sure to apply blood when the blood drop appears on the display.

Discarding Used Lancets

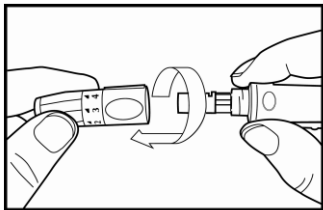

1. Unscrew and remove the cap.

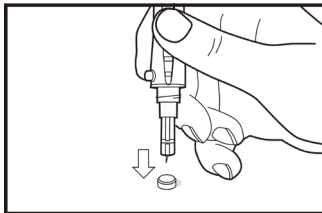

2. Without touching the used lancet, stick the lancet tip into its protective cover.

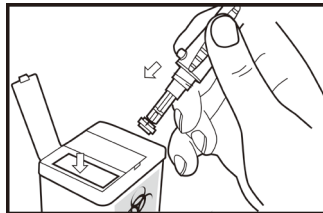

3. Pointing the lancing device toward a container for sharp or biohazard material, slide the ejection button down to release the covered lancet into the container.
4. After discarding, wash hands thoroughly with soap and water. Rinse and dry thoroughly.

Understanding Your Test Results

Expected Values*

The **EASYMAX®** Blood Glucose test strips are plasma referenced and calibrated for easier comparison to lab results. The normal fasting blood glucose range for an adult with diabetes is 70-130 mg/dL*. Two hours after meals, the blood glucose range for an adult with diabetes is less than 180 mg/dL. For people with diabetes: please consult your healthcare professional for the blood glucose range appropriate for you.

* Reference: American Diabetes Association. Standards of medical care in diabetes. Diabetes care. 2013; Vol. 36, Suppl 1:S11-66

Unusual Test Results

If your test result doesn't match the way you feel, please follow these steps:

1. Run a control solution test, Chapter 2 "Control Solution Testing."
2. Repeat a blood glucose test, Chapter 3 "Testing Your Blood glucose."
3. If your test results still don't reflect the way you feel, call your doctor immediately.

Note:

1. **Extremely high humidity may affect the test results. A relative humidity above 90% may cause inaccurate results.**
2. **Hematocrit below 30% may cause higher results. Hematocrit above 55% may cause lower results.**

Comparing Your Meter Result to a Lab Result

A common question is how the blood glucose results on your meter compare to the lab results. Your blood glucose can change quickly, especially after eating, taking medication, or exercising. If you test yourself in the morning, then go to the doctor's office for a blood glucose test. The results will probably not match, even if you are fasting. This is typically not a problem with your meter, it just means that time has elapsed, and your blood glucose has changed.

If you want to compare your meter result to the lab result, you must be fasting. Bring your meter to the doctor's office and test yourself by fingertip within five minutes of having blood drawn from your arm by a healthcare professional. Keep in mind that the lab could use different technology than **EASYMAX® T1** blood glucose meter, and that blood glucose meters for self-testing generally read somewhat lower or higher than the lab result.

For accuracy and precision data and for important information on limitations, see the instructions that come with your test strips.

Chapter 4: Maintenance and Troubleshooting

Installing Batteries

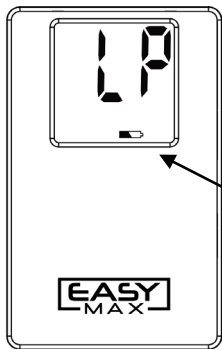

The meter uses one CR2032 lithium battery. Battery will normally last for more than 1000 tests. Other types of CR2032 lithium batteries are also acceptable, but the capacity of test times may differ. Install the batteries when you first use the meter or replace them with new batteries when the "LP" (low power) message and the low battery symbol appear on the display.

Low battery symbol

Note:

- 1. CR2032 battery is available at most stores. You may take the old battery with you for replacement.**
- 2. Remove the battery when you will not be using the meter for one month or more.**

Cleaning And Disinfecting Your Meter and Lancing Device

Choosing the disinfectant

The recommended EPA-registered disinfected product is as follow:

PDI® Super SANI-CLOTH® Germicidal disposable wipe (EPA Reg. No.:9480-4)

Super Sani-Cloth germicidal wipe contains active ingredients: n-Alkyl (60% C₁₄, 30%C₁₆, 5%C₁₂, 5%C₁₈) dimethyl benzyl ammonium chlorides and n-Alkyl (68%C₁₂, 32%C₁₄) dimethyl ethylbenzyl ammonium chlorides and they have been shown to be safe for use with the **EASYMAX® T1** Blood Glucose Meter, but any other disinfectant product with the EPA registration number may be used on this device.

Please purchase at your local retail store or ask your healthcare professional where to purchase. You could also purchase on the PDI website:<http://www.pdipdi.com/> or online retail sites such as: amazon.com, medline.com, and Expression medical supply Inc. <http://www.exmed.net/>.

Cleaning and Disinfection Instruction

Please keep the meter and lancing device free of dirt, dust, bloodstain, and water stains. Please follow the following guidelines to clean and disinfect your meter and lancing device.

The meter and lancing device have been validated so that they can withstand cleaning up to 9 times per day. After every use, follow the cleaning instructions to prevent the growth of any microorganism and to help improve the effectiveness of disinfection. Then follow disinfection instruction once per week which could effectively eliminate blood borne pathogens, such as viral hepatitis and prevent cross-contamination. If the devices are being operated by a second

person who is providing testing assistance to the user, the meter and lancing device should be disinfected prior to use by the second person.

Cleaning Instruction: All blood and other body fluids must be thoroughly cleaned from surfaces and objects before disinfection by the germicidal wipe. Open, unfold and use germicidal wipe to remove heavy soil after every use.

Disinfection Instruction: Unfold a clean wipe and thoroughly wet all the surface of the meter, including the strip port and other connection port. Unfold a clean wipe and thoroughly wet all the surface of the lancing device, including cap or AST cap if used. The treated area must remain visibly wet for a full 2 minutes. Let the devices air dry for 1 minute. Do disinfection once per week.

Do:

- Make sure the meter is turned off during cleaning and disinfection.
- After cleaning or disinfection, please perform the physical appearance and performance check of devices.
- Please follow the instruction on page 31 to 34.

Do Not:

- Get any moisture in the test strip slot.
- Spray any cleaning solution directly onto the meter.
- Put the meter under water.
- Pour liquid on or into the meter.

Meter cleaning area

Code	Name	Possibility of contact with blood
A	Screen Cover	High
B	Strip Slot	High
C	Case	Medium
D	Battery Cover	Low

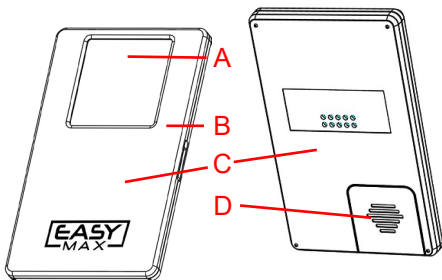

Lancing device cleaning area

Code	Name	Possibility of contact with blood
A	Lancet holder	High
B	Trigger button	High
C	Body	High
D	Sliding barrel	High
E	Cap	High
F	Depth adjust ring	High

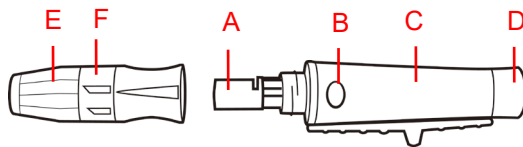

Physical Appearance check of the meter after each cleaning or disinfection

Check item	Accept Result
Is it clear to see through the transparency part, like display?	Yes
Is the strip slot and other components free from erosion or debris?	Yes
Is the labeling on the meter legible?	Yes
Action: If any of the results are “No” the user should call the Customer Care Service toll-free at 866-994-3345 (Eastern Standard Time, Mon-Fri 8:00AM~6:00PM) for assistance.	

Performance check of the accessories

Steps	Check item	Accept Result
<i>After each disinfection</i>		
1. Insert test strip	Is the meter powered on?	Yes
2. Apply Level 2 control solution	Any reading?	Yes
	Is the reading within control range?	Yes
3. Remove test strip	Is the meter powered off?	Yes
Action: If any of the results are “No”, stop using the device. Please call the Customer Care Service toll-free at 866-994-3345 (Eastern Standard Time, Mon-Fri 8:00AM~6:00PM) for replacement with a new meter.		

Physical Appearance check of the lancing device after each cleaning or disinfection

Check item	Accept Result
Are all components free from erosion or debris?	Yes
Action: If any of the results are “No” the user should call the Customer Care Service toll-free at 866-994-3345 (Eastern Standard Time, Mon-Fri 8:00AM~6:00PM) for assistance.	

Performance check of the Lancing device

Step	Check item	Accept Result
<i>After each cleaning</i>		
1. Cap the normal cap to the lancing device.	Can the cap be screwed on the lancing device?	Yes
2. Pull on the sliding barrel and then release.	Can the lancing device click?	Yes
3. Press trigger button.	Can the lancet be fired?	Yes
<i>After each disinfection</i>		
1. Install the lancet on the lancet holder.	Can the lancet be fixed on the lancet holder?	Yes
2. Cap the AST cap to the lancing device.	Can the AST cap be screwed on the lancing device?	Yes
3. Remove the AST cap. Recap the normal cap to the lancing device.	Can the cap be screwed on the lancing device?	Yes
	Can the penetration depth ring be adjusted?	Yes
4. Pull on the sliding barrel and then release.	Can the lancing device click?	Yes
5. Press trigger button.	Can the lancet be fired?	Yes
Action: If any of the results are “No”, please call the Customer Care Service toll-free at 866-994-3345 (Eastern Standard Time, Mon-Fri 8:00AM~6:00PM) for replacement with a new device.		

Cleaning and Disinfection Frequency

The meter and lancing device can sustain 14,000 cleaning cycles and 208 disinfection cycles which represents cleaning 9 times per day and disinfecting (with a pre-clean step) once per week over the 4 year use life of the device.

4 year product life is for properly cleaning and disinfection. After 4 years, the meter must be replaced with a new meter.

Maintenance And Testing

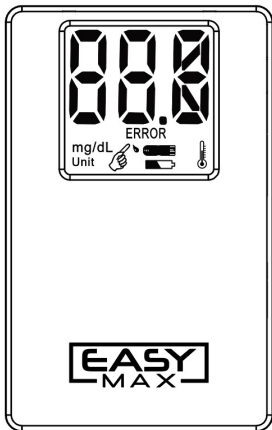

Your meter needs little or no maintenance with normal use. Just keep the meter free of dirt, dust, bloodstain, and water stains. Follow these guidelines carefully to help you get the best performance possible: Do gently wipe the meter's surface with a soft cloth. Do not get any moisture in the test strip slot.

Screen Messages and Troubleshooting

Never make treatment decisions based on an error message. If you have any concerns, call the Customer Care Service toll-free at **866-994-3345 (Eastern Standard Time, Mon-Fri 8:00AM~6:00PM)**.

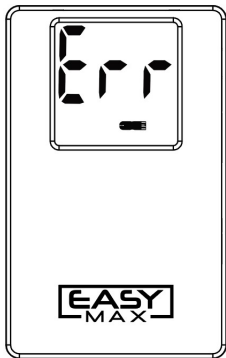

Humidified/Used strips

Action: Replace with a new strip.

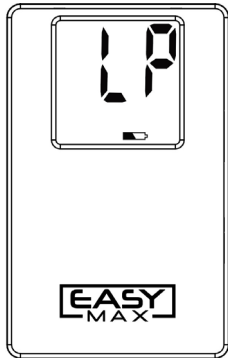

Low power

Action: Replace with new batteries.

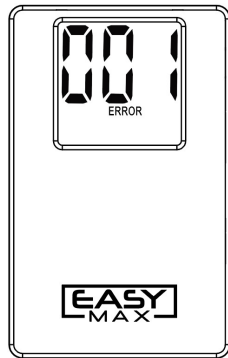

System fault

Action: Remove and reinstall the batteries first. If **ERROR 001** appears again, please call the Customer Care Service toll-free at **866-994-3345 (Eastern Standard Time, Mon-Fri 8:00AM~6:00PM)**. During non-service hours, please contact your local dealer.

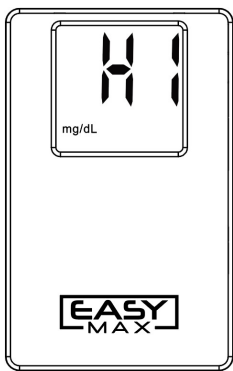

Test result is higher than 600 mg/dL.
Action: Test again. If the result is still the same, try a control solution test and if the control solution test falls within the correct range, please call the Customer Care Service toll-free at **866-994-3345 (Eastern Standard Time, Mon-Fri 8:00AM~6:00PM)**. During non-service hours, please contact your healthcare provider.

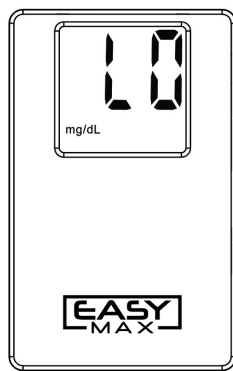

The test result is lower than 20 mg/dL.
Action: Test again. If the result is still the same, try a control solution test and if the control solution test falls within the correct range, please call the Customer Care Service toll-free at **866-994-3345 (Eastern Standard Time, Mon-Fri 8:00AM~6:00PM)**. During non-service hours, please contact your healthcare provider.

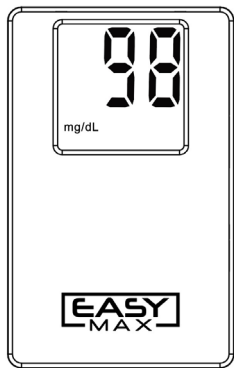

Meter Memory

Action: Your meter will always show your last test result when inserting a new test strip for a new measurement.

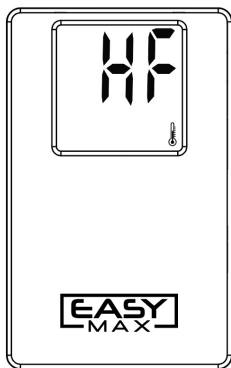

The "HF" and thermometer icon appears. Temperature is too high, outside the required range of 50°F - 104°F (10°C - 40°C). This alerts users that an incorrect result may occur if the test continues.

Action: Relocate the meter to a location with temperature between 50°F - 104°F (10°C - 40°C).

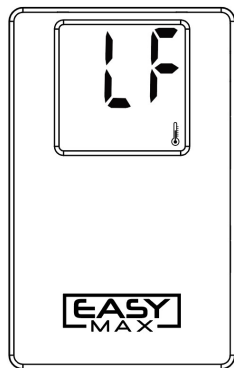

The "LF" and thermometer icon appears. Temperature is too low, outside the required range of 50°F - 104°F (10°C - 40°C). This alerts users that an incorrect result may occur if the test continues.

Action: Relocate the meter to a location with temperature between 50°F - 104°F (10°C - 40°C).

Chapter 6: Technical Information

Specifications

Brand name		EASYMAX® T1 Blood Glucose Meter
Range		20~600 mg/dL
Test time		5 seconds
Operating condition	Temp.	50°F - 104°F (10°C - 40°C)
	Relative Humidity	R.H. ≤ 90%
Blood sample		0.6 µL
		Fresh blood from fingertip
Hematocrit (Hct)		30-55%
Power		1 x CR2032 Lithium Battery
Battery life		Over 1000 tests
Display dimension		30 × 30 (mm)
Device dimension H × W × D (mm)		80 × 50 × 5 (mm)
Weight		22 grams w/o batteries
Principles		Electrochemical biosensor technology

Limitation

The test strips are used for fresh capillary whole blood samples.

1. DO NOT use neonate blood sample.
2. Extreme humidity may affect the results. A relative humidity greater than 90% may cause incorrect results.
3. The system should be used at a temperature between 50°F - 104°F (10°C - 40°C). Outside this range, the system may get incorrect results.
4. DO NOT reuse the test strips. The test strips are for single use only.
5. Hematocrit: The hematocrits between 30% and 55% will not significantly affect the results. Hematocrit below 30% may cause higher results. Hematocrit above 55% may cause lower results. If you do not know your hematocrit level, please consult with your healthcare professional.
6. Altitude up to 10,000 feet above sea level has no effect on readings.

Healthcare Professionals – Please note these additional Limitations.

1. Patients undergoing oxygen therapy may have inaccurate results.
2. If the patient has the following conditions, the result may fail:
 - ◆ Severe dehydration
 - ◆ Severe hypotension (low blood pressure)
 - ◆ Shock

◆ A state of hypoglycemic-hyperosmolar state (with or without ketosis)

3. Lipemic samples: Cholesterol level up to 500 mg/dL and triglycerides up to 3,000 mg/dL do not affect the results. Grossly lipemic patient samples have not been tested and are not recommended for testing with **EASYMAX® T1** Blood Glucose Meter.
4. Critically ill patients should not be tested with home-use blood glucose meters.
5. Interfering Substances depend on concentration. The chart below shows substances and the test concentration amount that will not affect the blood glucose results.

Interfering Substance	Test Concentration mg/dL	Bias at 50±5 mg/dL	% Bias at 250±5 mg/dL	% Bias at 500±5 mg/dL
Acetaminophen	8	10.2	6.5	3.8
Ascorbic Acid	2.5	11.8	-6.8	5.3
Dopamine	2	4.3	12.9	6.3
Gentisic Acid	6	7.8	2.8	-4.3
L-Dopa	2	3.8	-1.2	-1.8
Methyldopa	2	5.2	-2.3	4.1
Uric Acid	13	7.6	3.9	3.8

Device Information

EASYMAX® T1 SMBG System

EASYMAX® T1 Blood Glucose Meter

EASYMAX® Blood Glucose Test Strips

EASYMAX® Level 2 Control Solution

EASYMAX® Level 3 Control Solution

Manufacturer for:

Oak Tree Health

9550 South Easter Ave. Suite 253, Las Vegas, NV 89123

www.oaktree-health.com

Lancing Device & Lancet

Meets the requirements of MDD 93/42/EEC

Manufacturer:

Shandong Lianfa Medical Plastic Products Co., Ltd.

No.1, Sanshan Avenue, Shuangshan, Zhangqiu District, Jinan City, Shandong Province

TEL: 86-531-61328777 E-mail: linkfar@sdlianfa.com

Warranty

EASYMAX® warrants the original purchaser for a period of 3 years from the date of purchase. This means during the warranty period if your Self-Monitoring Blood Glucose System does not work for any reason (other than obvious abuse), we will replace it with a new system or an equivalent product free of charge.

Please read **EASYMAX® T1** User's Manual before operation. If you have any questions and/or need assistance, please contact us as follows:

- Within the USA, call toll-free: **866-994-3345 (Eastern Standard Time, Mon-Fri 8:00AM~6:00PM)**. During non-service hours, please contact your healthcare provider.
- Outside the USA, call your authorized representative or write to:
Customer Service E-mail: info@epsbio.com.tw

EASY
MAX[®] T1



EASY
MAX[®] T1

EASY
MAX[®] T1